

Rubber Washer

Size indication & tolerance chart

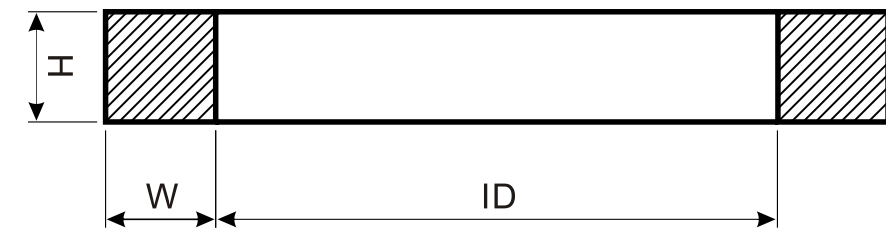

Rubber washer/Square ring is mainly used for shock absorption application or seal the gap in the static fluid (For example, water, oil, air, chemicals solvent, chemicals, etc.)



ID	Tol (+/-)	W	Tol (+/-)
4-14.00	0.13	0-1.68	0.15
14.01-15.60	0.18	1.69-2.51	0.15
15.61-25.12	0.23	2.52-3.40	0.15
25.13-29.78	0.25	3.41-5.16	0.15
29.79-34.65	0.28	5.17-6.73	0.15
34.66-44.17	0.33	6.74----	0.20
44.18-50.52	0.38		
50.53-66.40	0.46		
66.41-75.92	0.51		
75.93-94.97	0.61		
94.98-107.67	0.69		
107.68-126.72	0.76		
126.73-133.07	0.94		
133.08-158.42	0.89		
158.43-183.82	1.02		
183.83-209.22	1.14		
209.23-234.62	1.27		
234.63-278.99	1.40		
279.00-405.26	1.65		
405.27-430.66	1.91		
430.67-456.07	2.03		
456.08 ----	0.50%		
		H	Tol (+/-)
		0-1.68	0.08
		1.69-2.51	0.10
		2.52-3.40	0.10
		3.41-5.16	0.10
		5.17-6.73	0.10
		6.74----	0.15